

SETUP INSTRUCTIONS

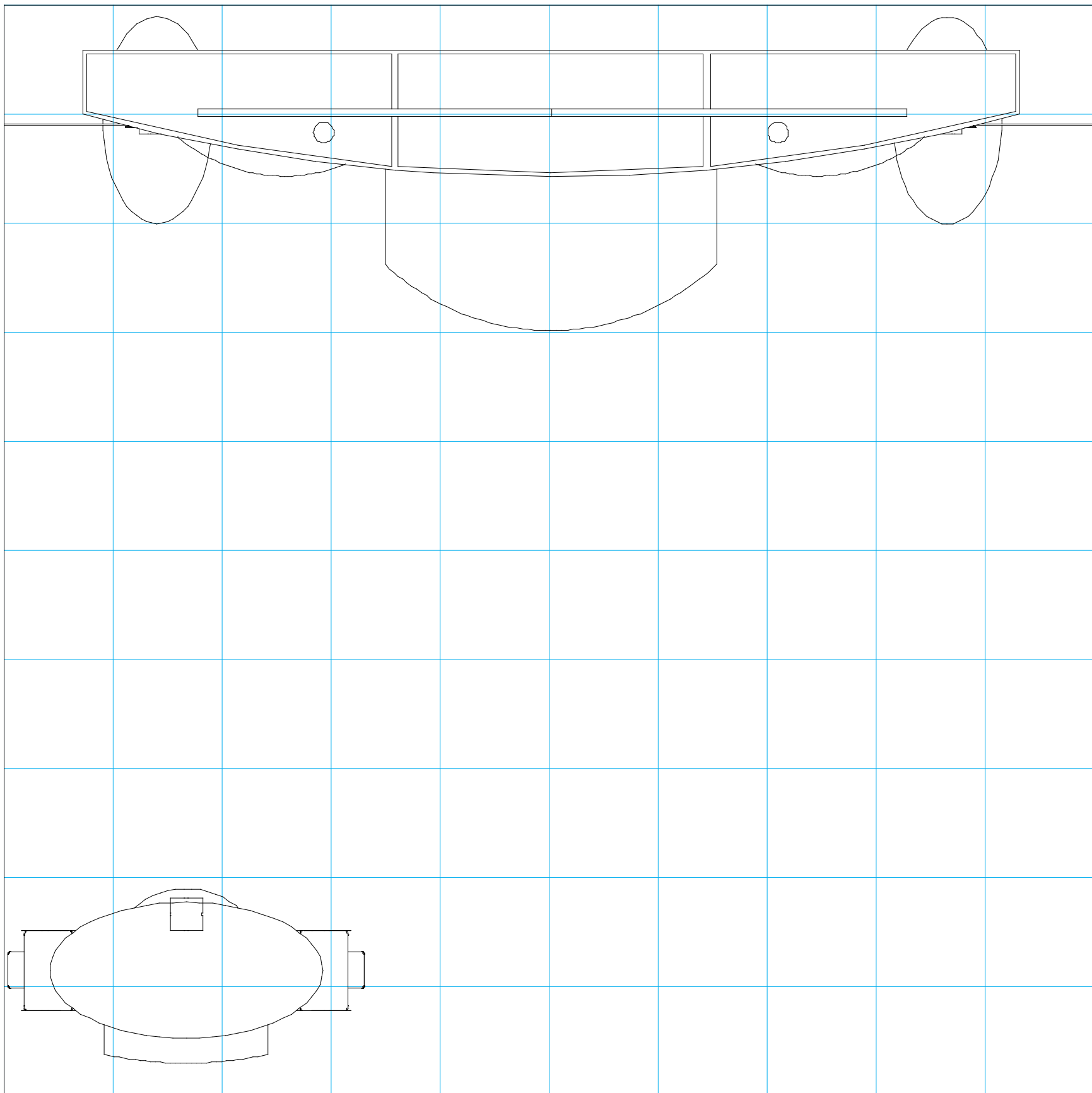

= 1 sq foot

General Setup Instructions

- Read entire setup instruction manual prior to unpacking parts and pieces.
- The setup instructions are created specifically for this configuration.
- Setup instructions are laid out sequentially in steps, including exploded views with detailed explanation for assembly.

Cleaning & Packing

- For Cleaning Metal, Plex, & Laminate Parts: Use a **MILD NON-ABRASIVE** cleanser and soft cloth/paper towel to clean all surfaces.
- Keep exhibit components away from heat and prolonged sun exposure. **Heat and UV exposure will warp and fade components.**
- Retain all provided Packing Materials. All provided packing materials are for ease of repacking & component protection.

Disassembly

- For loss prevention, tighten all set screws and locks during disassembly.

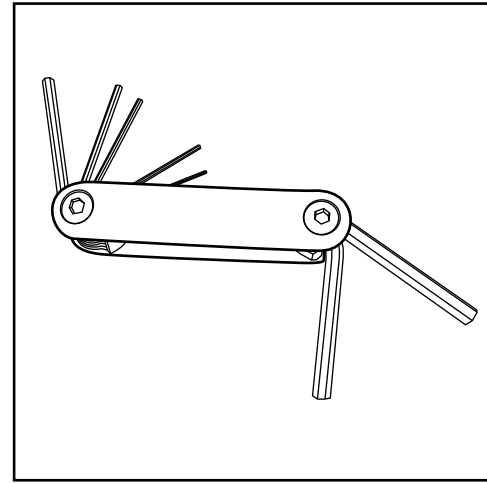

Hex Tool - Essential for Assembly

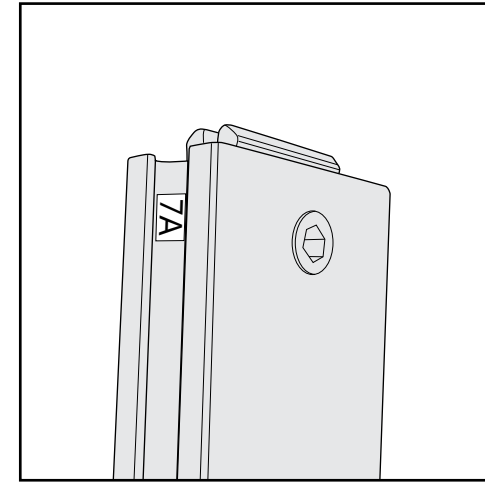

Part Identification - Numbering

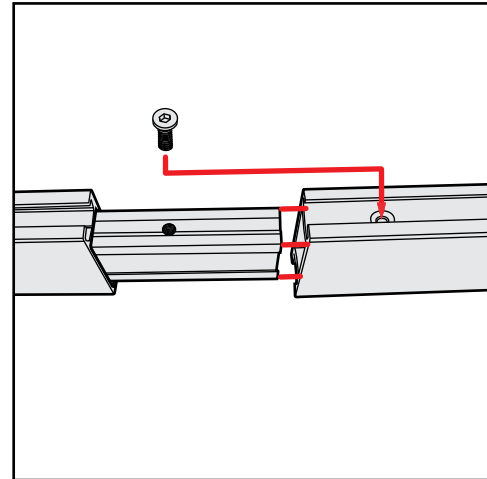

Spline Connection

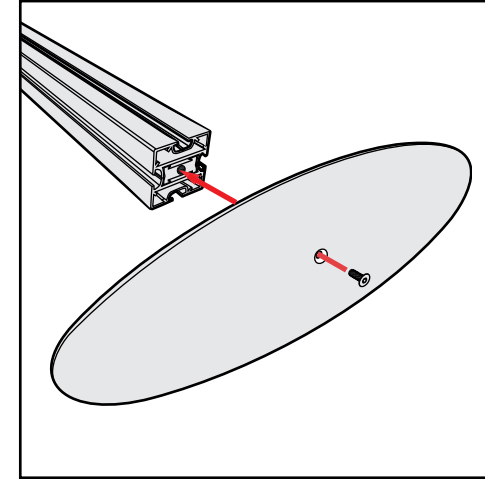

Base Plate & Extrusion Connection

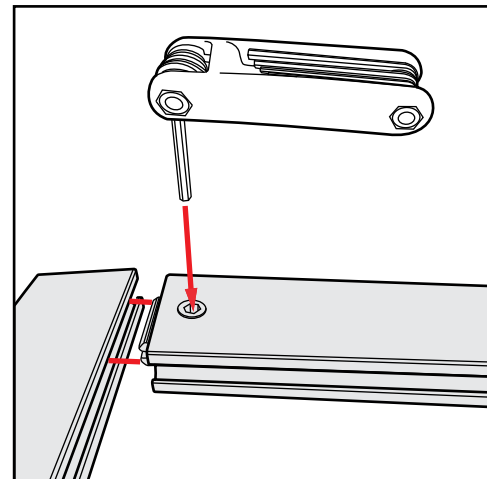

Extrusion & Lock Connection

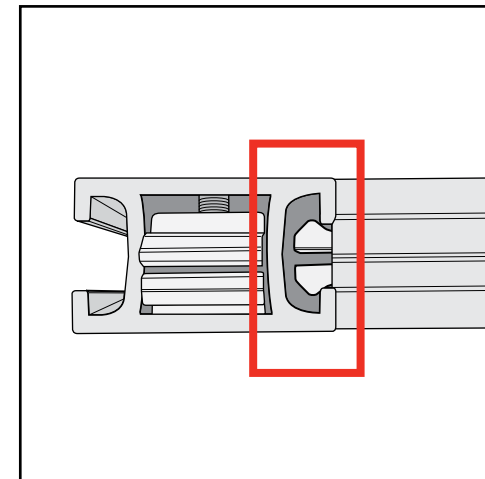

Engaged Lock



WARNING

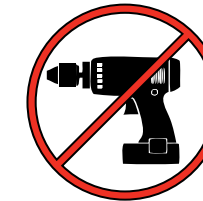

DO NOT USE POWER TOOLS



LADDERS OR LIFTS
MAY BE REQUIRED



ALL CONNECTIONS MUST
BE TIGHTLY SECURED

CRATE PACKING

Item	Qty.	Description
18	1	78" Header Horizontal Extrusion
18A	1	78" Header Horizontal Extrusion with holes and bolts
19	2	5.823" Header Horizontal Extrusion

Steps:

- 1) Attach vertical extrusions [19] between horizontal extrusions [18 & 18A].
Note: Place infills between horizontal and vertical extrusions as shown.
- 2) Attach header assembly to ceiling using bolts and wing nuts as shown.
- 3) Attach puck lights from under into holes at bottom of ceiling as shown.
Note: Light bulb must face down.

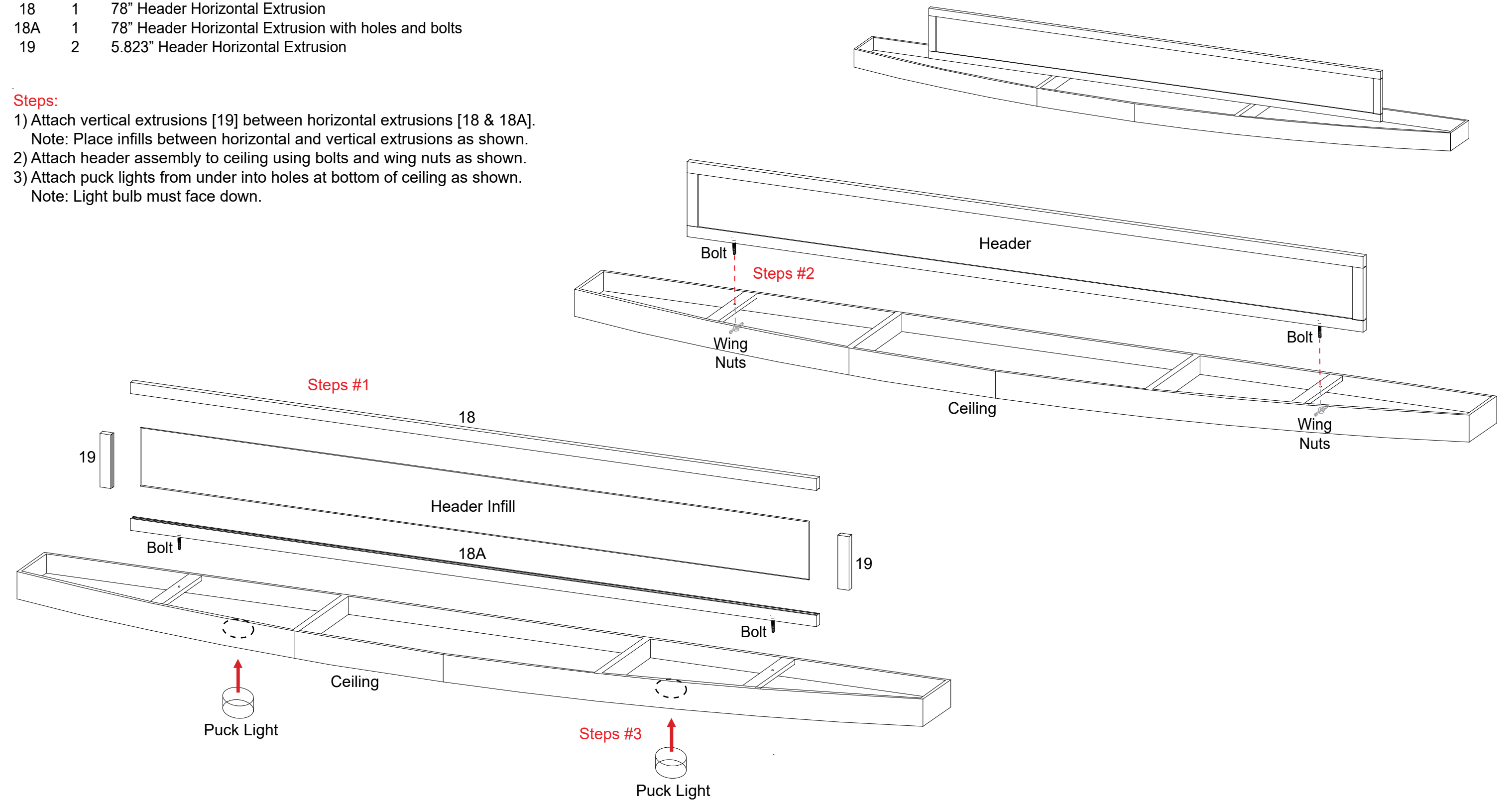

Item	Qty.	Description
6	1	38" Round Vertical Extrusion
7	1	38" Round Vertical Extrusion
15	2	12.5" Horizontal Extrusion
16	2	28.3203" Curved Extrusion
17	1	38" Angled Vertical Extrusion w/ Door Stopper
17A	1	38" Angled Vertical Extrusion w/ Door Hinges

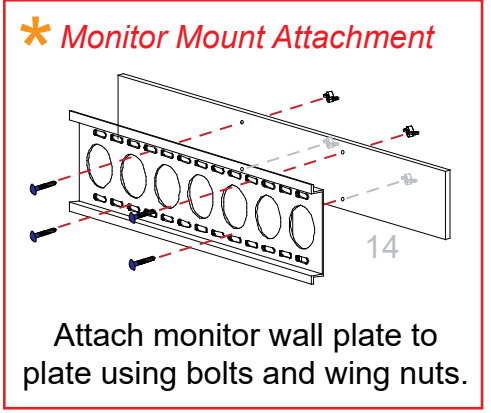
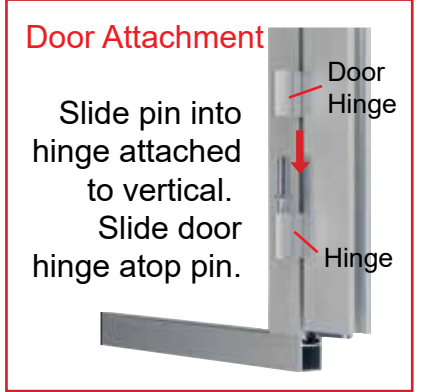

- Steps:
- 1) Attach angled vertical extrusions [17 & 17A] to verticals [6 & 7]. **** Refer to V10 Pressure Screw Attachment detail.**
 - 2) Attach upper and lower horizontal extrusions [15] between verticals [6 & 4] and [7 & 5]. Note: Place infills between horizontal and vertical extrusions as shown.
 - 3) Attach upper and lower horizontal curved extrusions [16] between vertical extrusions [17 & 17A]. Note: Attach door between horizontal and vertical extrusions as shown. Refer to **Door Attachment** detail.
 - 4) Attach monitor mount to horizontal plate [14]. Refer to **Monitor Mount Attachment** detail.
 - 5) Velcro attach shelf supports to inside of backwall counter.
 - 6) Place internal shelf atop shelf supports.
 - 7) Place counter top atop assembled backwall counter.
 - 8) Place ceiling with header atop assembled backwall and secure in place using bolts as shown.

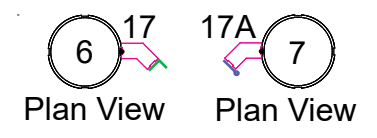
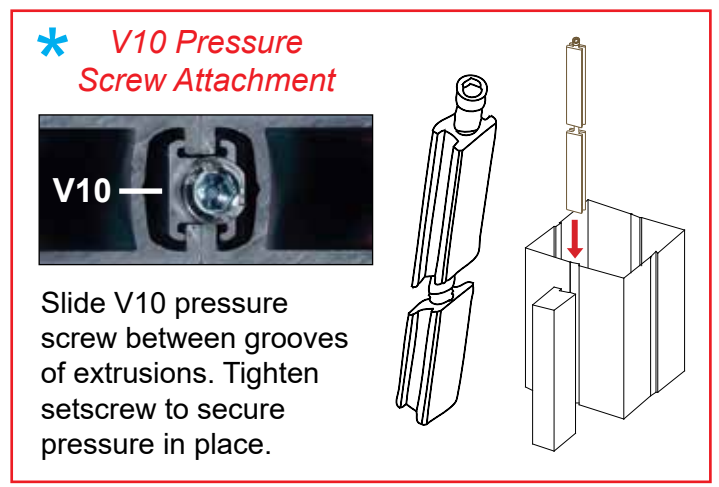
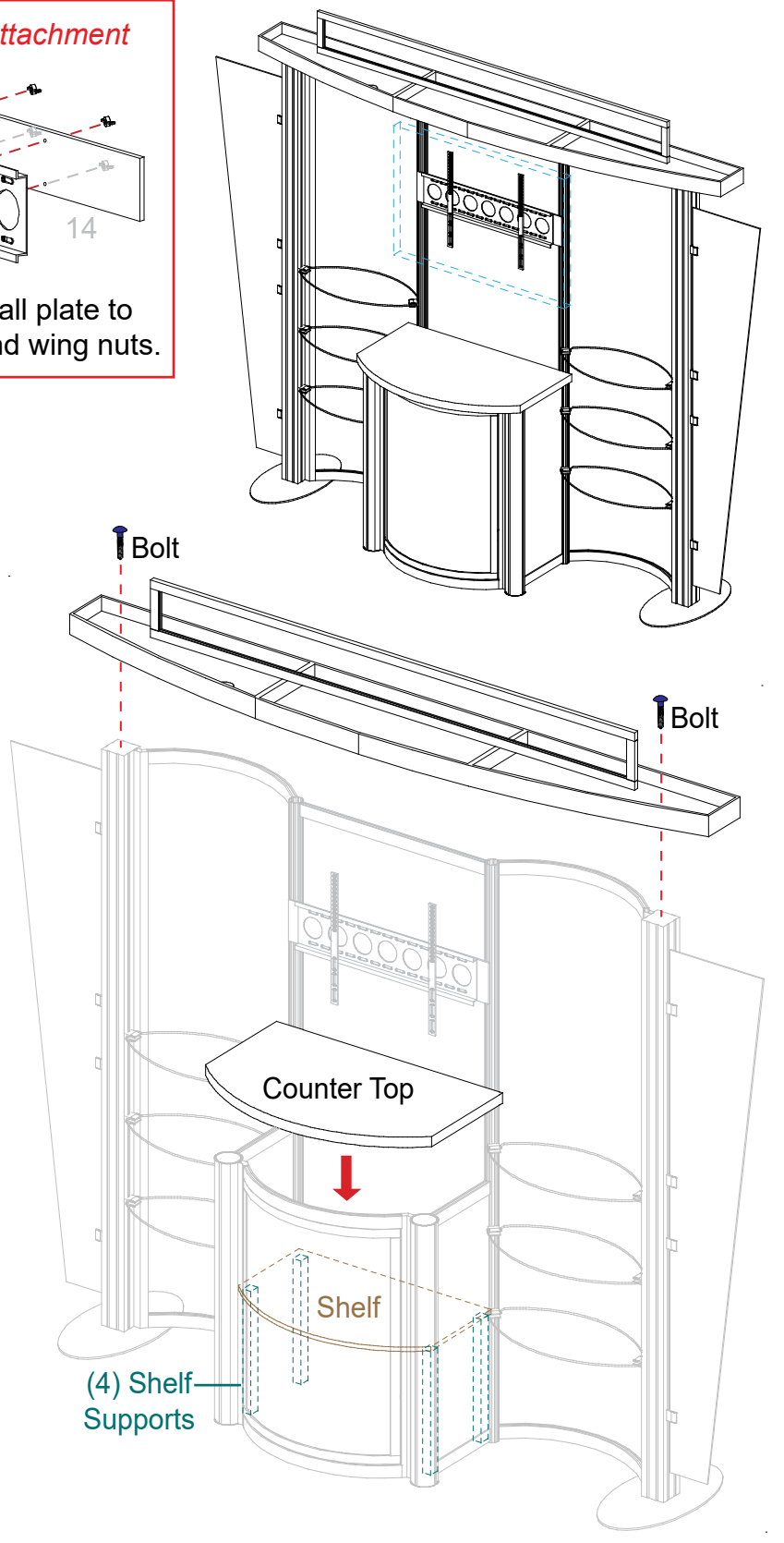
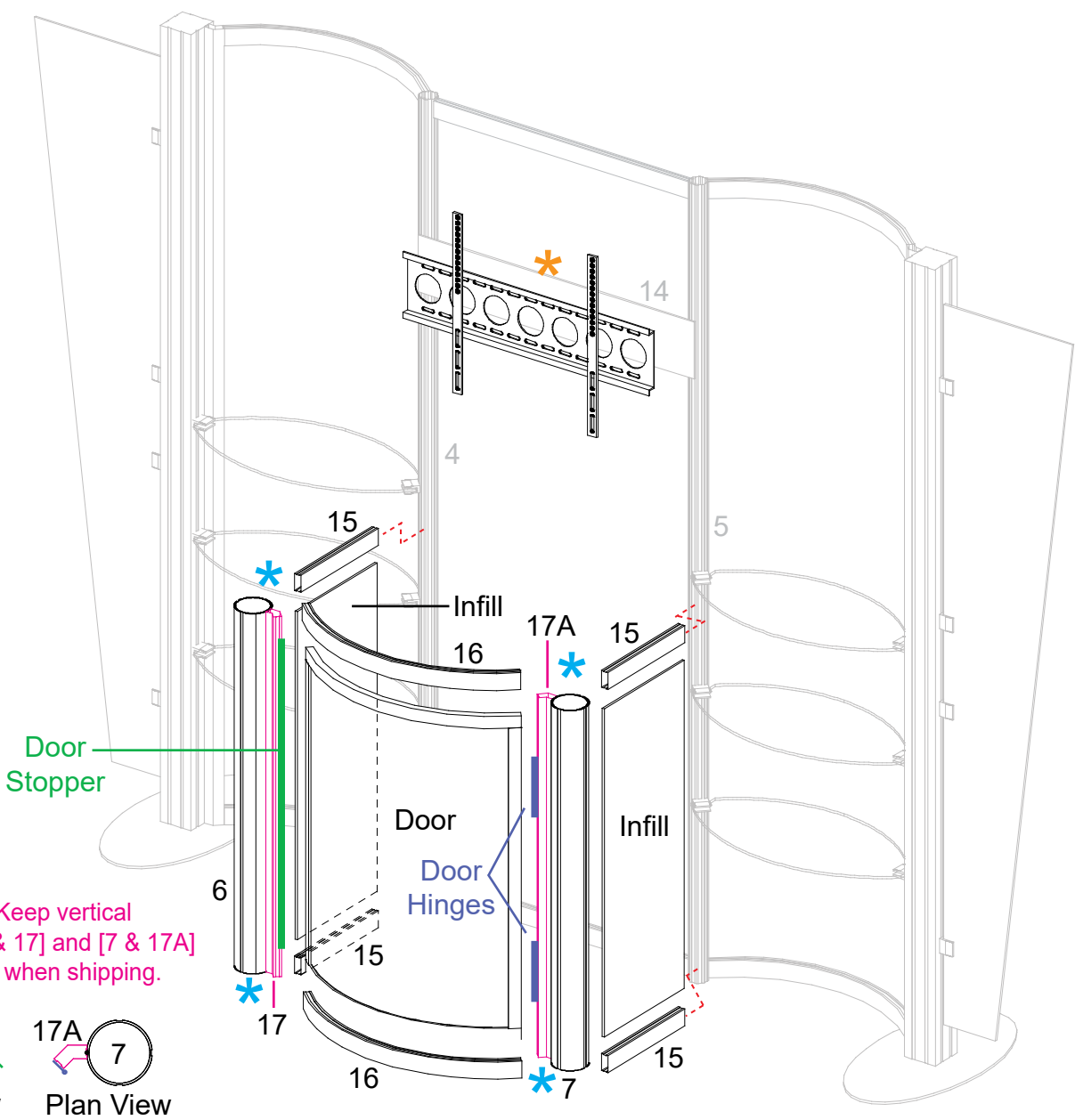

Item	Qty.	Description
20	1	Round Base Plate
21	1	38.125" h Left Diagonal Extrusion w/ A10 Clamps Attached
22	1	38.125" h Right Diagonal Extrusion w/ A10 Clamps Attached
23	1	60" Square Vertical Extrusion
24	1	16" Horizontal Extrusion w/ Angle Cut Both Ends

- Steps:**
- 1) Attach diagonal extrusions [21 & 22] and square vertical extrusion [23] to round base plate [20].
 - 2) Place infill into groove between diagonal extrusions [21 & 22].
 - 3) Attach horizontal extrusion [24] between diagonal extrusions [21 & 22] at top.
 - 4) Place counter top atop horizontal support [24] and attach to vertical extrusion [23].
Refer to **Counter Attachment** detail.
 - 5) Attach shelves to diagonal extrusions [21 & 22] with A10 Clamps. **
Refer to **Example of A10 Clamp Attachment** detail.
 - 6) Attach literature pockets to diagonal extrusions [21 & 22].
Refer to **Literature Rack Attachment** detail.
 - 7) Attach monitor mount plate to vertical extrusion [23].
Refer to **Monitor Mount Attachment** detail.

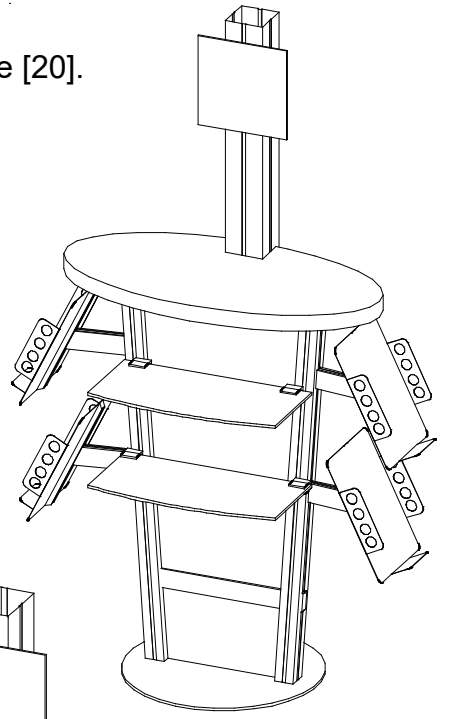

Monitor Mount Attachment

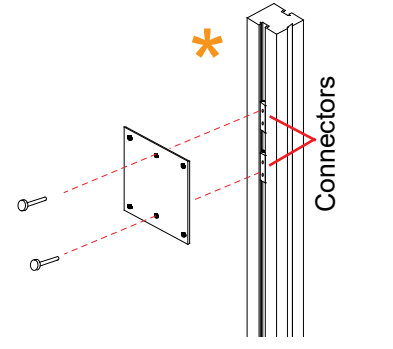

Attach monitor mount back plate to connectors using setscrews provided.

**Note: Keep A10 Clamps assembled with vertical extrusion when shipping.

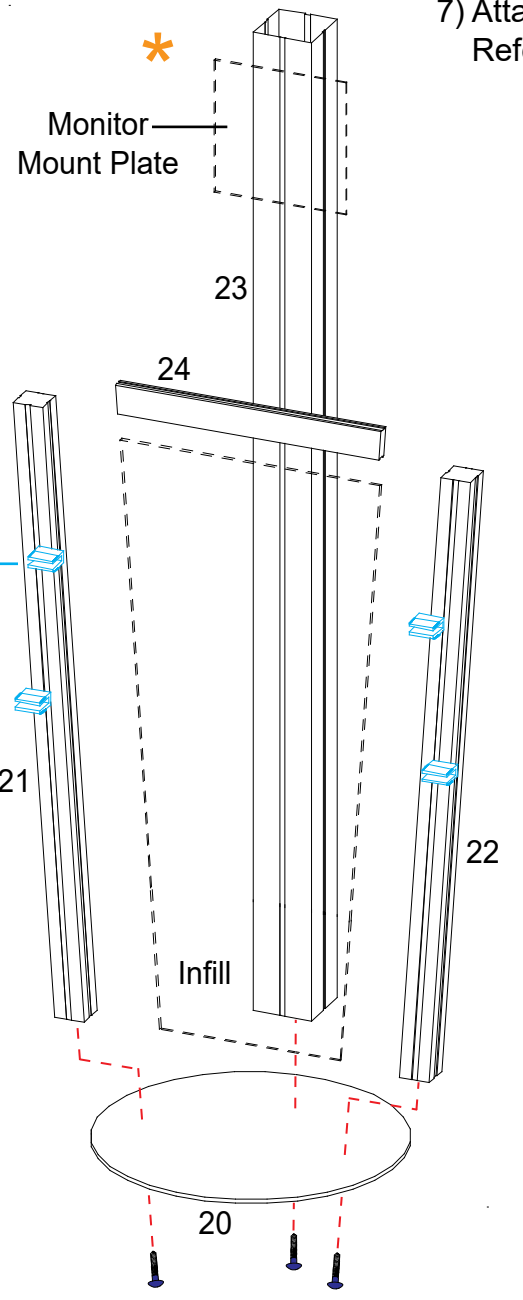

Counter Attachment

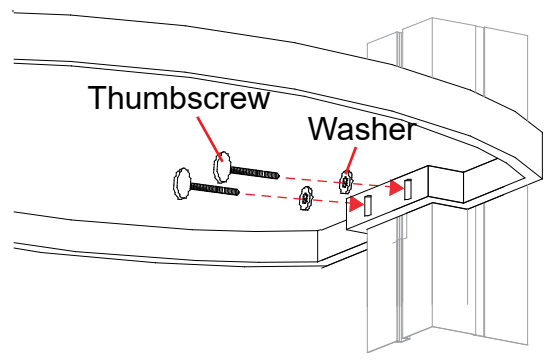

After setting counter on horizontal support, put washer on thumbscrew, and attach thumbscrew through counter to vertical extrusion as shown.

Literature Rack Attachment

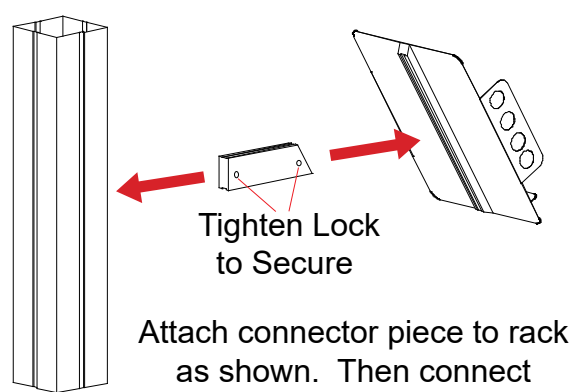

Attach connector piece to rack as shown. Then connect assembled literature rack to vertical extrusion.

Example of A10 Clamp Attachment

