

Plan View

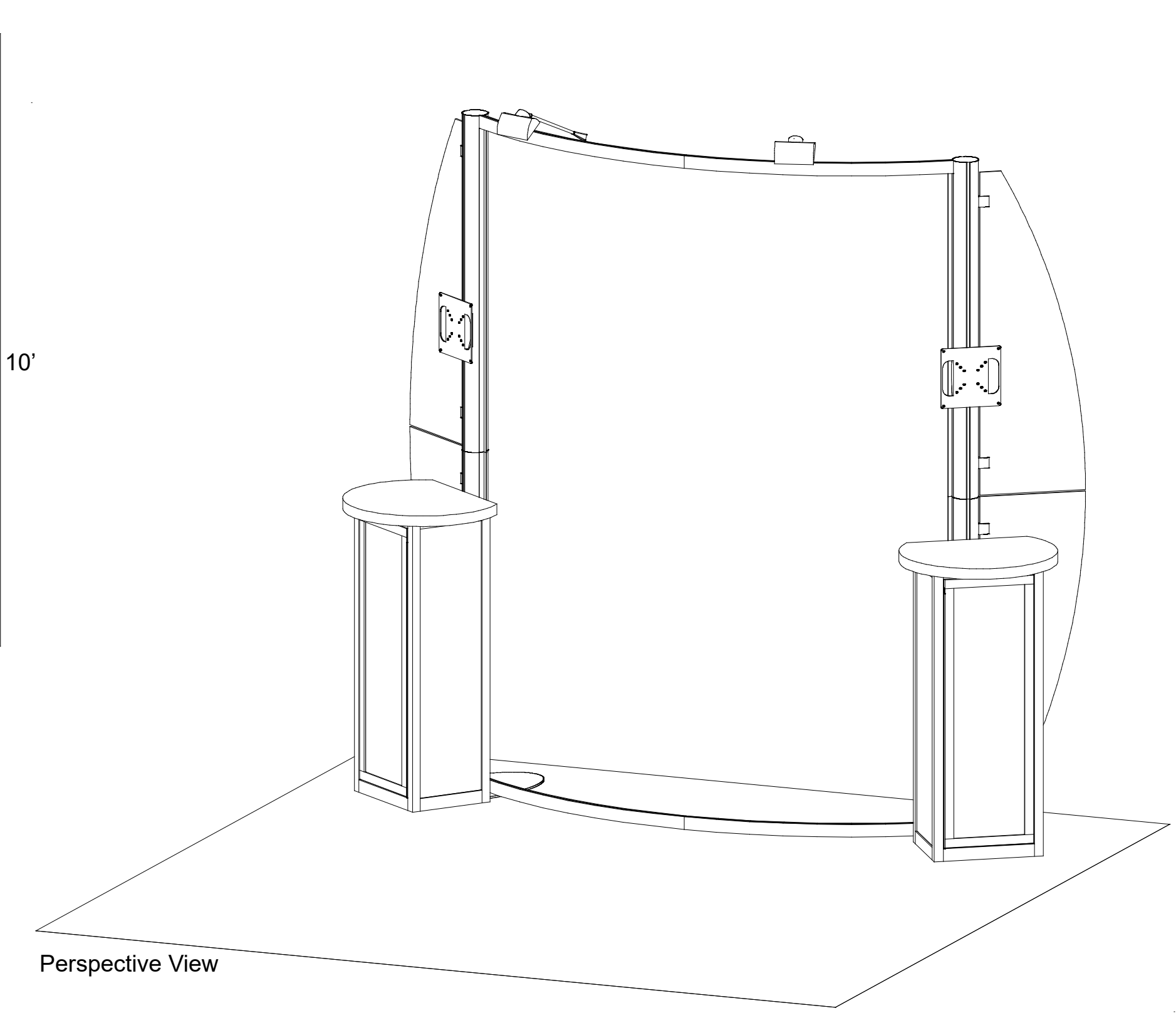

Perspective View

# ***SETUP INSTRUCTIONS***

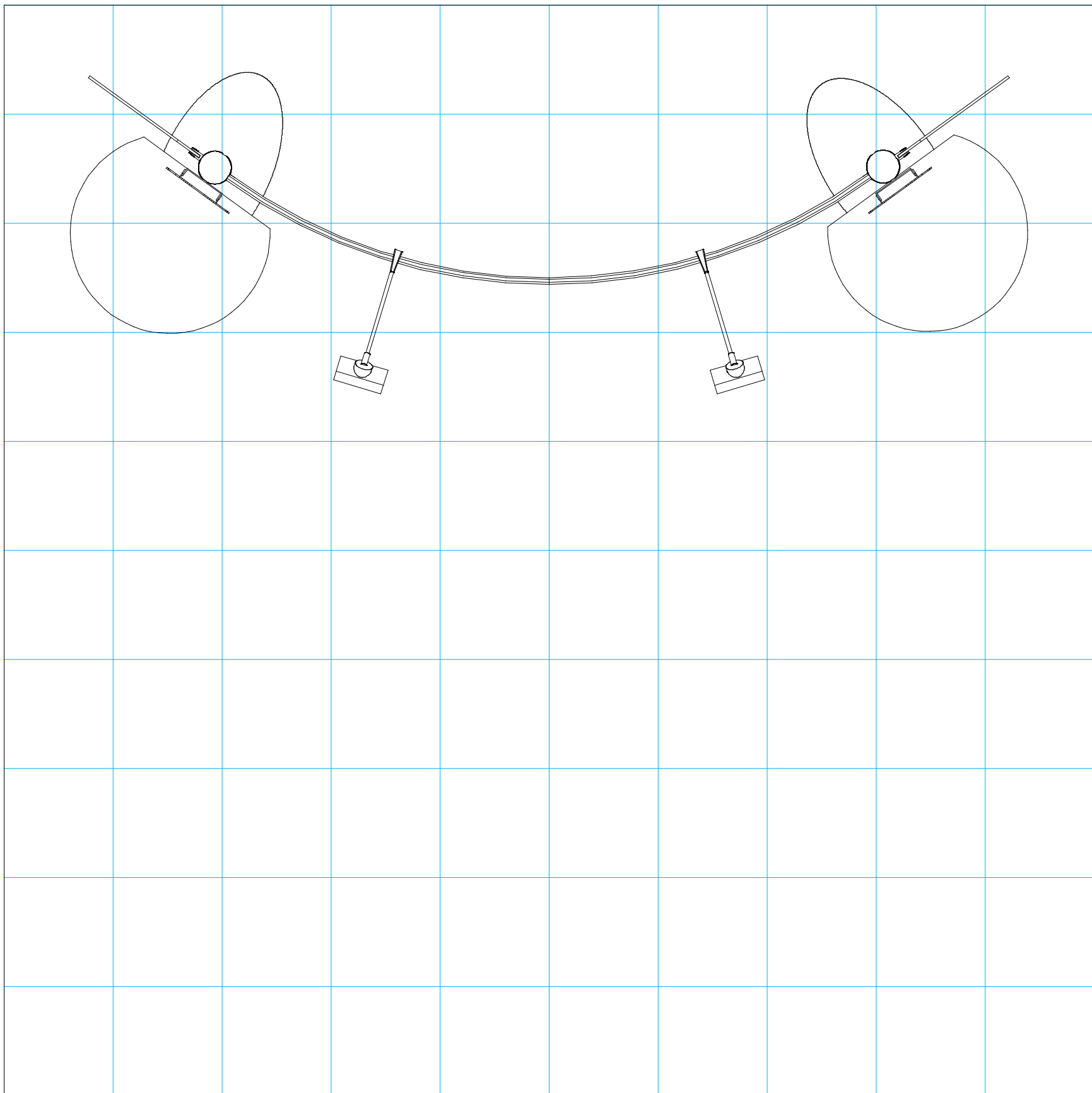

= 1 sq foot

## General Setup Instructions

- Read entire setup instruction manual prior to unpacking parts and pieces.
- The setup instructions are created specifically for this configuration.
- Setup instructions are laid out sequentially in steps, including exploded views with detailed explanation for assembly.

## Cleaning & Packing

- For Cleaning Metal, Plex, & Laminate Parts: Use a **MILD NON-ABRASIVE** cleanser and soft cloth/paper towel to clean all surfaces.
- Keep exhibit components away from heat and prolonged sun exposure.  
**Heat and UV exposure will warp and fade components.**
- Retain all provided Packing Materials. All provided packing materials are for ease of repacking & component protection.

## Disassembly

- For loss prevention, tighten all set screws and locks during disassembly.

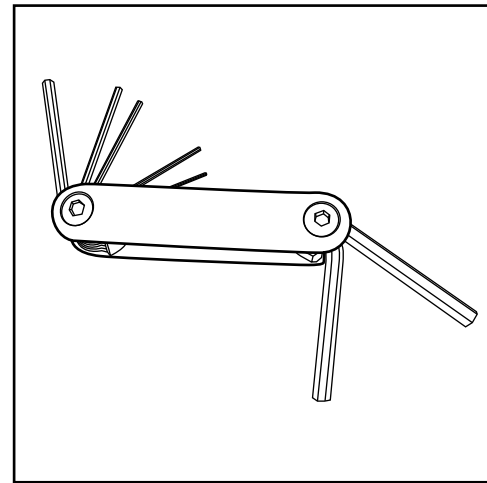

Hex Tool - Essential for Assembly

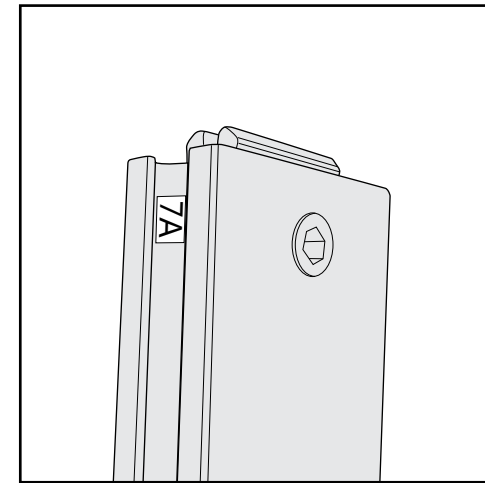

Part Identification - Numbering

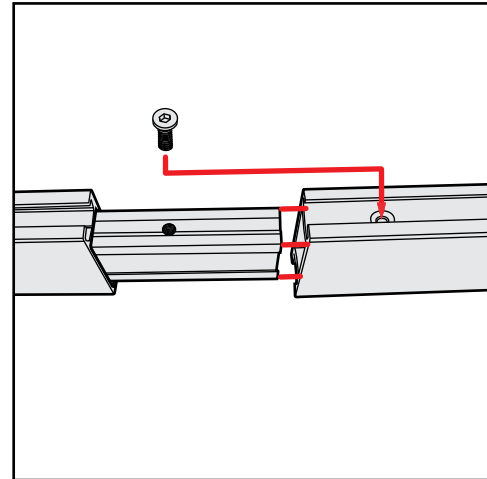

Spline Connection

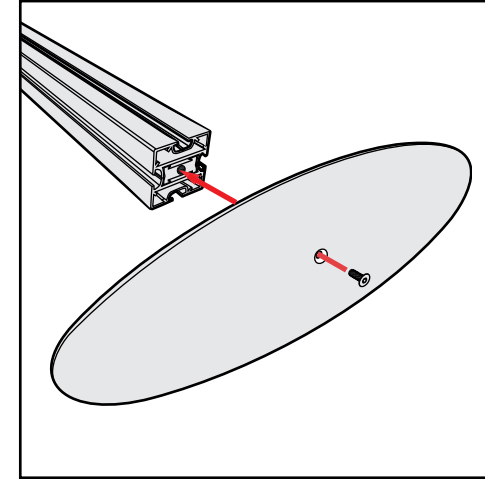

Base Plate & Extrusion Connection

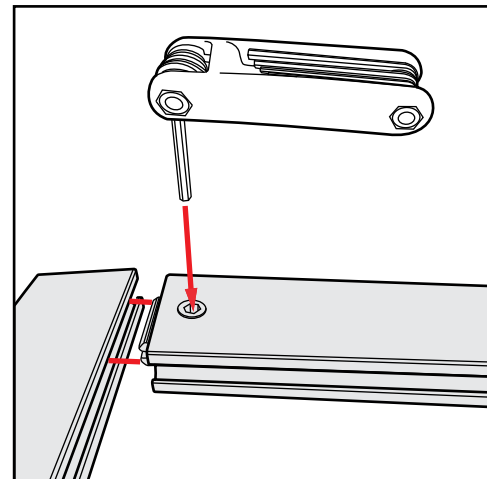

Extrusion & Lock Connection

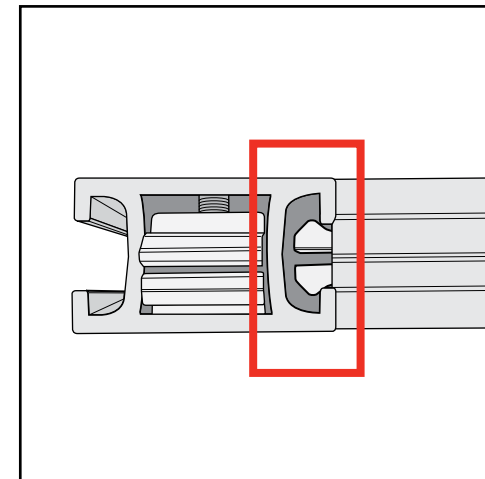

Engaged Lock



**WARNING**



DO NOT USE POWER TOOLS

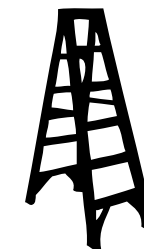

LADDERS OR LIFTS  
MAY BE REQUIRED



ALL CONNECTIONS MUST  
BE TIGHTLY SECURED

### Top View of Each Level

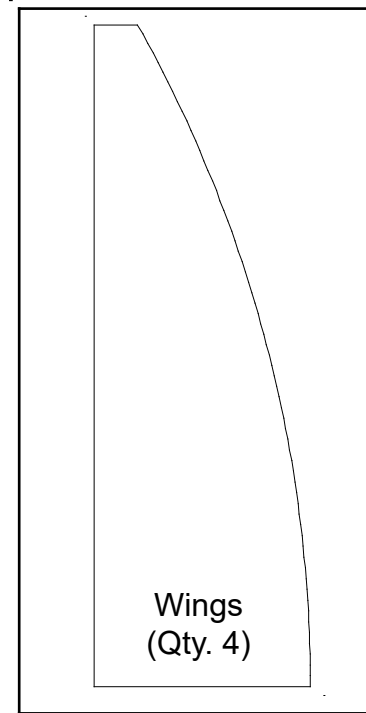

Level 1  
(Bottom level)

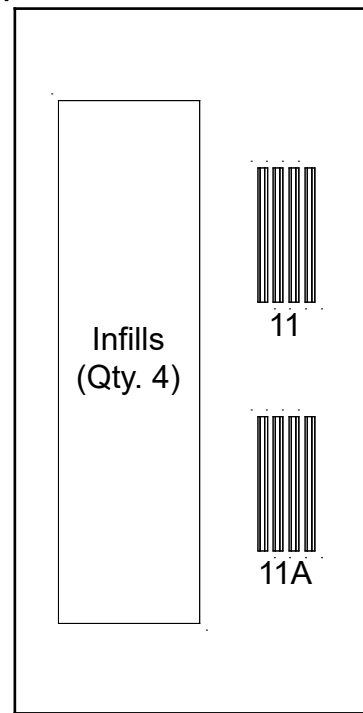

Level 2

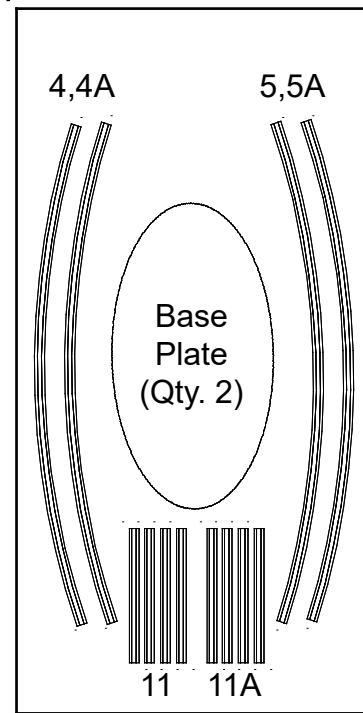

Level 3

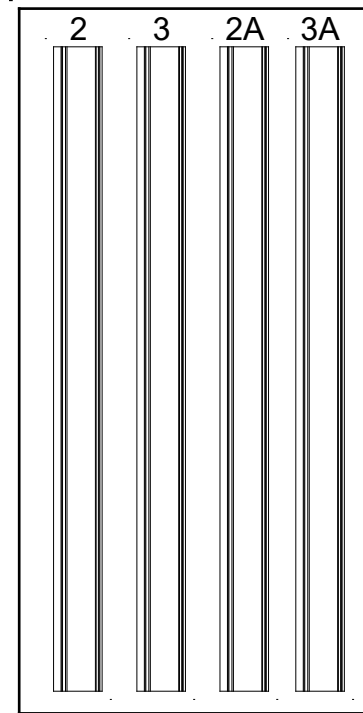

Level 4

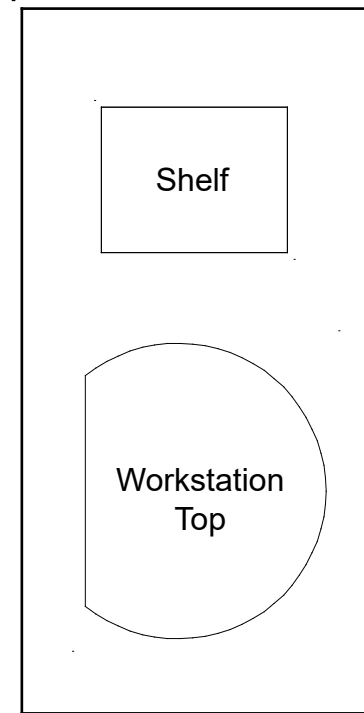

Level 5

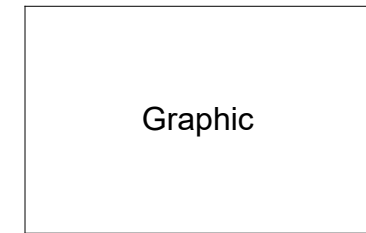
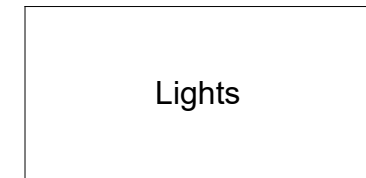

### Top View of Each Level

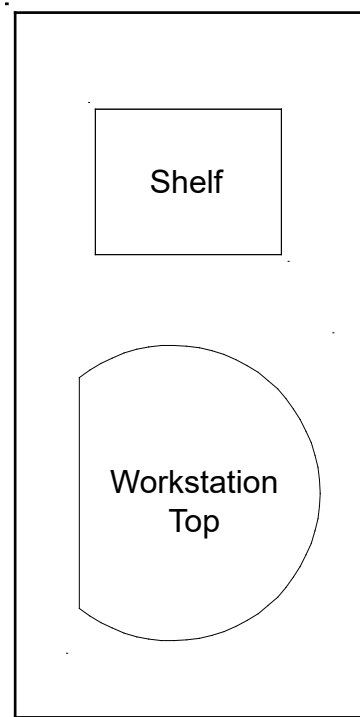

Level 1  
*(Bottom level)*

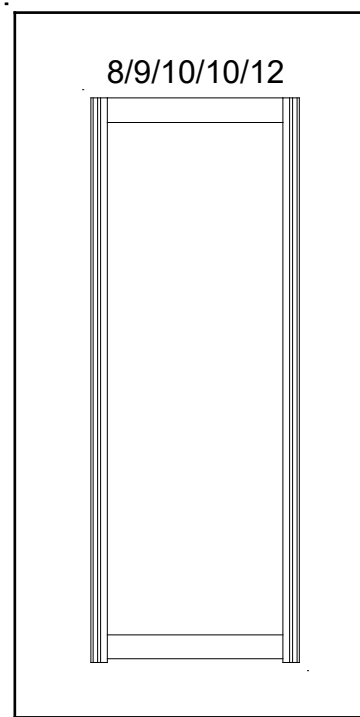

Level 2

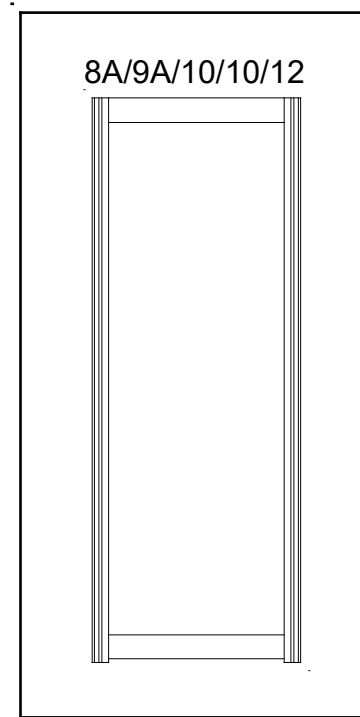

Level 3

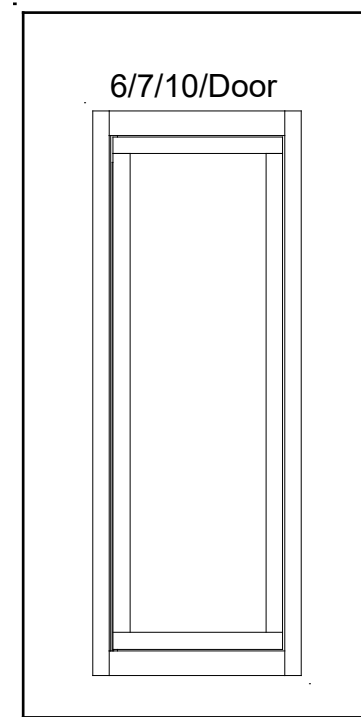

Level 4

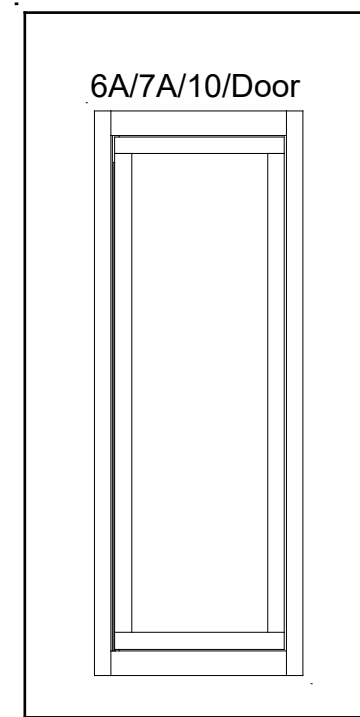

Level 5

Item	Qty.	Description
1	1	Base Plate
2,2A	1,1	48" RR91 Vertical Extrusion w/ PR37
3,3A	1,1	48" RR91 Vertical Extrusion w/ PR37
4,4A	1,1	38" Z45 Curved Horizontal Extrusion
5,5A	1,1	38" Z45 Curved Horizontal Extrusion

- Steps:
- 1) Attach base plates to verticals [2] and [3], using bolts.
  - 2) Connect verticals [2] to [2A] and [3] to [3A].  
See **Extrusion Connector** detail.
  - 3) Connect horizontals [4] to [4A] and [5] to [5A].
  - 4) Attach horizontal assemblies between vertical assemblies.
  - 5) Connect graphic to Velcro on back of assembled backwall.

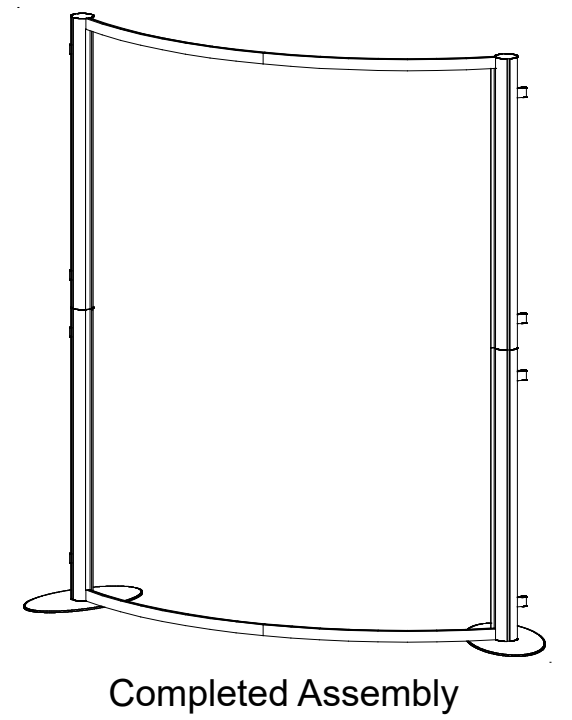

**\* PR37 Extrusion Attachment**

Slide PR37 extrusion into groove of RR91 then tighten set screws.  
**Note: Keep PR37 extrusion attached when disassembling & packing.**

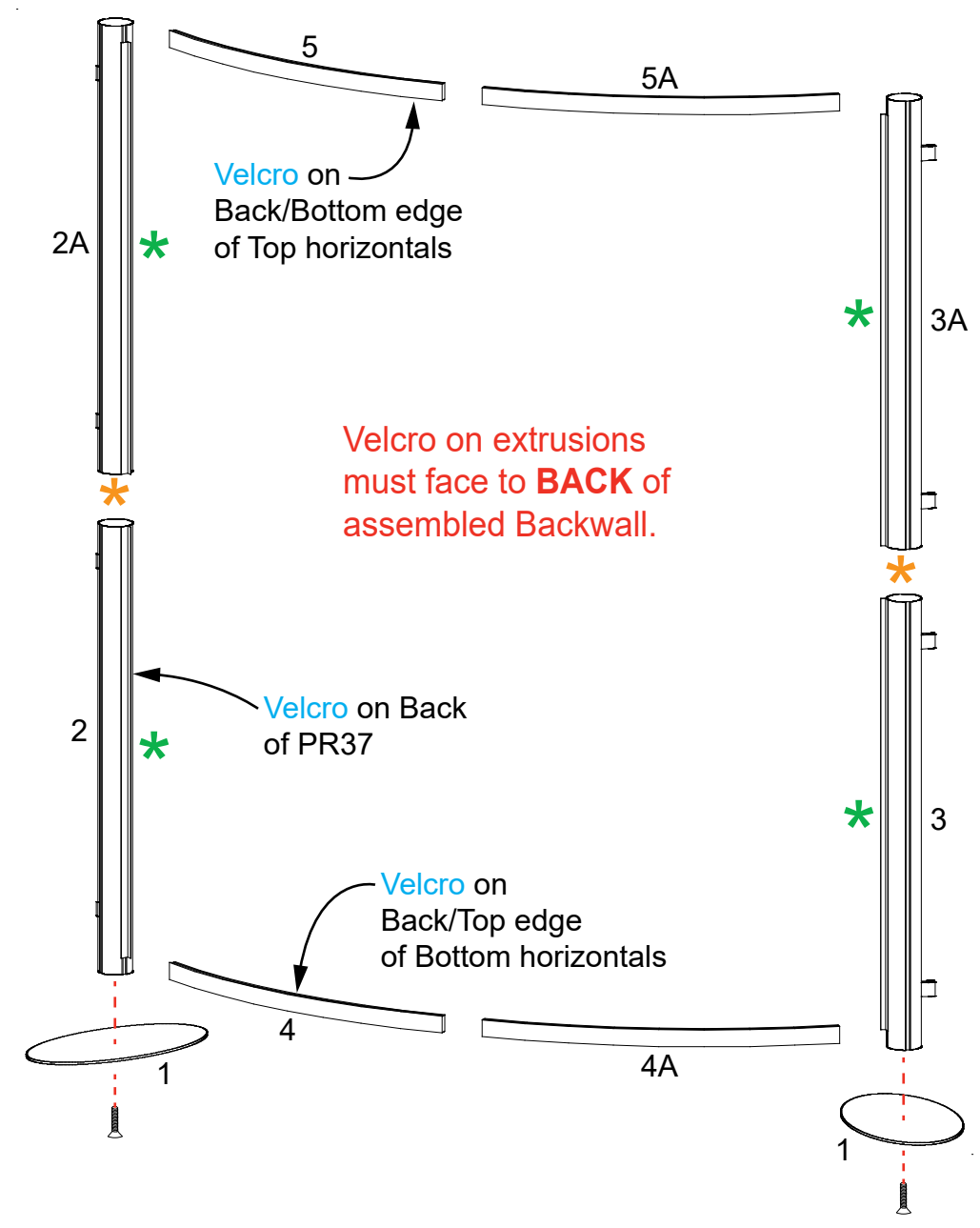

**\* Extrusion Connector**

Slide upper extrusion over connector and rest on lower extrusion. Secure with set screws.

**To prevent product loss, keep all screws attached to connector after disassembling.**

Item	Qty.	Description
6,6A	1,1	42" GS220 Vertical Extrusion w/ Door Stop
7,7A	1,1	42" GS220 Vertical Extrusion w/ Door Hinges
8,8A	1,1	42" GS220 Vertical Extrusion
9,9A	1,1	42" GS220 Vertical Extrusion
10	8	13" Z41 Horizontal Extrusion
11,11A	4,4	10" Z41 Horizontal Extrusion

- Steps:**
- 1) Attach horizontals between verticals, inserting **Infills**, as shown.  
Make sure Velcro is facing inward.
  - 2) Connect doors to verticals [7] and [7A]. See **Door Connection** detail.
  - 3) Attach **shelf supports** to Velcro inside of assembled workstation, then place shelf on top of supports.
  - 4) Place workstation top onto assembled base. See **Workstation Top Attachment** detail.

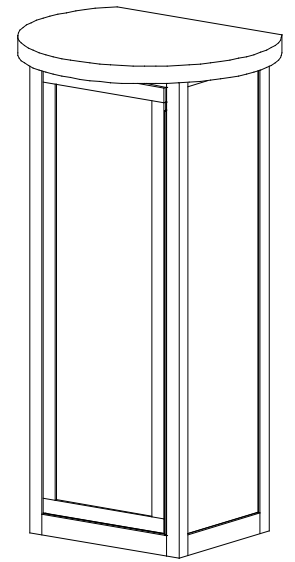

Completed Assembly

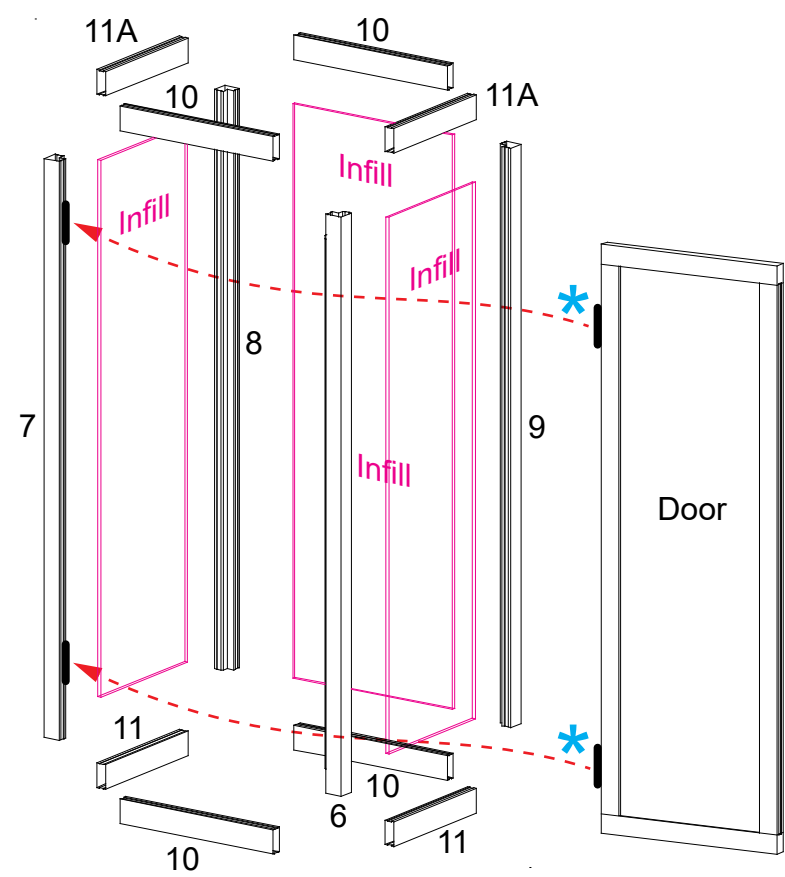

Left Workstation Base

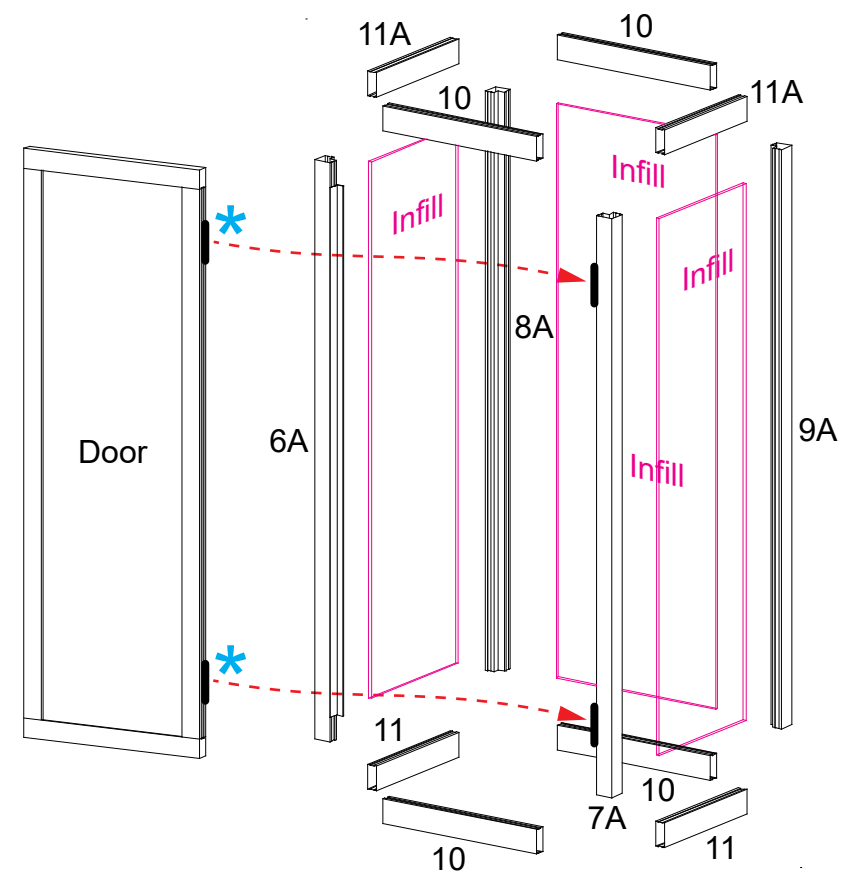

Right Workstation Base

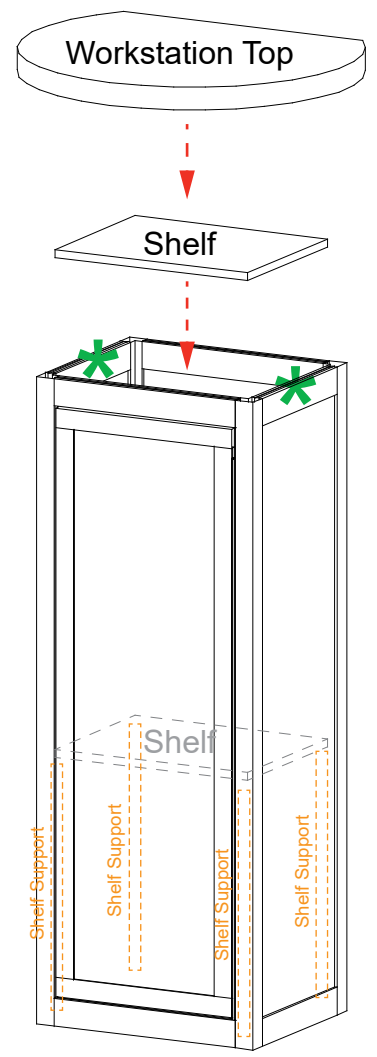
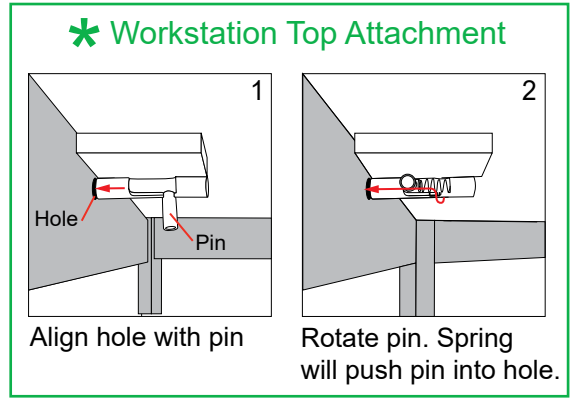
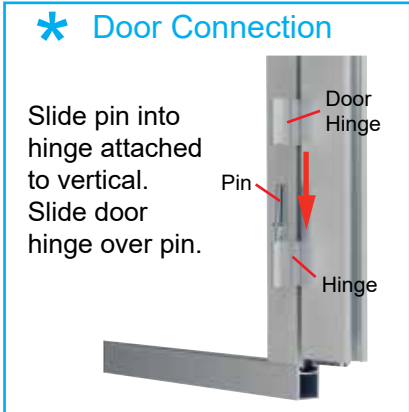

Steps:

- 1) Attach wings to A10 clamps. See [A10 Clamp](#) detail.
- 2) Connect lights to [5] [5A] assembly. See [Light Connection](#) detail.
- 3) Attach monitor mounts to [2A] and [3A]. See [Monitor Mount](#) detail.
- 4) Place assembled workstations next to extrusions [2] and [3].

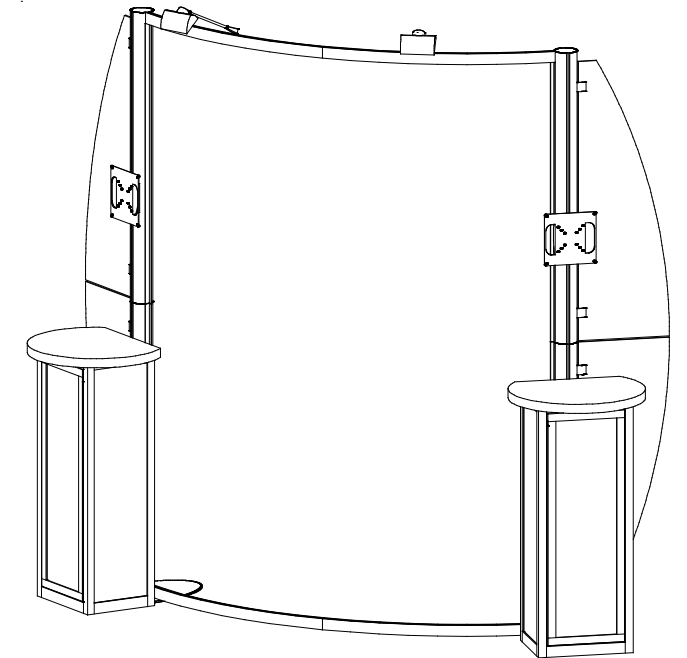

Completed Assembly

